

## Patient Access – Android device...

1. Download Microsoft Authenticator:



2. Download Patient Access App:



3. Register new account on Patient Access

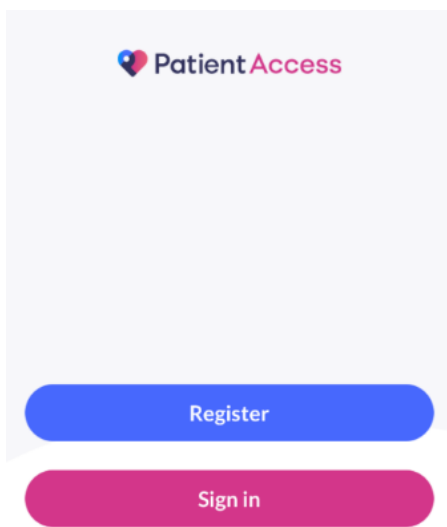

#### 4. Verify your email address

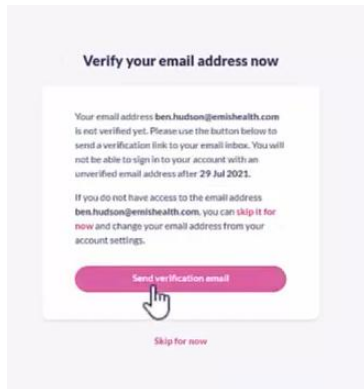

#### 5. Patient Access now must be linked to Microsoft Authenticator:

Account Name – Patient Access

Secret Key – Code from Patient Access

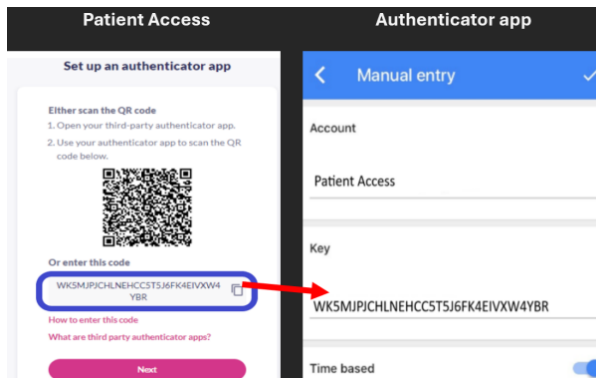

6. Open Microsoft Authenticator and press the + on the top corner. Add Other Account and add the code manually (unless you can scan the QR code from another device, Apple users can press and hold the QR and save it into Passcodes to generate the 6-digit code).

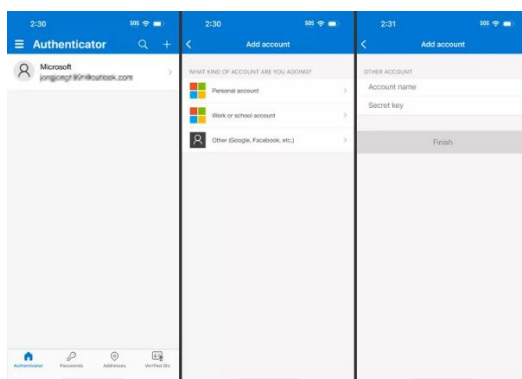

7. Enter the 6-digit code in Patient Access



8. If you have Biometrics on your device, you will have the option to use this for every log in rather than the Authenticator app.

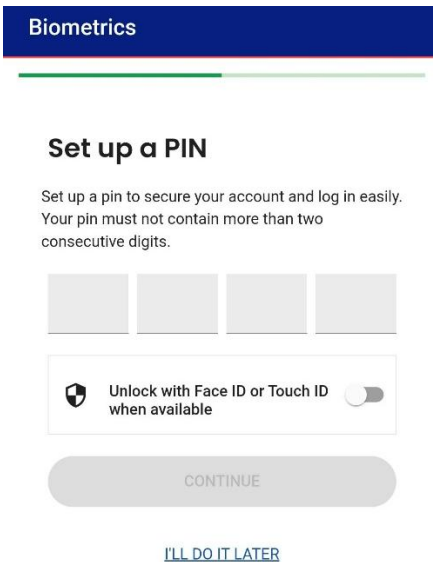

9. Link GP Practice using unique codes from EMIS – copy and paste if you have the email, or else manually input.

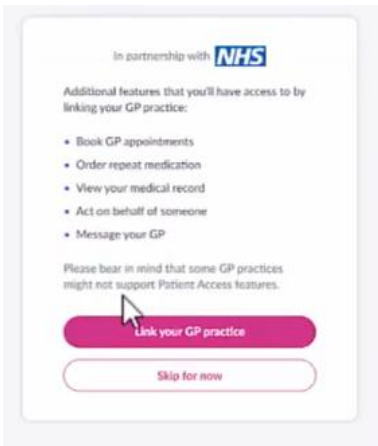

You have requested access to online services.

**Accessing online services**

To access online services:

- 1. Create an account with one of the following service providers:

Service provider	Website
Patient Access	<a href="https://www.patientaccess.com">https://www.patientaccess.com</a>
i-Patient	<a href="https://i-patient.net">https://i-patient.net</a>

- 2. Provide the following online services account details when prompted:

Linkage Key	cEypBGddUAQx5
ODS Code	100035
Account ID	602333100035